



## TDF...Series —DN15-DN40

- 
- caliber: DN15...DN40 (chilled/hot water)
  - valve body: brass
  - valve core: chromium plated brass
  - sealing element: NBR
  - surface treatment: slinging on surface
  - operating temperature: -10~110°C



## TDF...Series —DN50-DN500

- 
- caliber: DN50-DN500 (chilled/hot water)
  - flanged connection: GB/T9113.1-2000
  - valve body: ductile iron
  - valve core: stainless steel
  - sealing element: NBR
  - surface treatment: Anti-oxidation spraying
  - flow accuracy: ±5%
  - nominal pressure: 2.5MPa

## Application

It is mainly used for solving problem of hydraulic disorder in flow pipe. It can keep flow in the pipe constant when pressure fluctuates in operating differential pressure.

## Character

With the fluctuation of pressure, dynamic balancing valve core will move automatically to change the aperture, thus to keep the constant flow; So long as water differential pressure is within parameter, it can regulate equipment to reach required flow without any external force. Compact design saves installation room; simplified the computing workload of pipe system when designing; it is convenient to install. There is no need to do balance adjustment before running; stainless steel valve core assures corrosion resistance and long life which is a new energy-saving product at home and abroad. The differential pressure before and after should meet the requirement in the design phrase.

## Parameter selection sheet

Differential pressure Kpa		15~150	22~200	33~300	80~800
flow ( m <sup>3</sup> /h)	DN15~DN25	0.4~1.51	0.4~1.98	0.47~2.77	0.8~5.8
	DN32~DN40	0.4~2.95	0.4~3.46	0.47~4.32	0.8~7.52

Differential pressure Kpa		15~150	22~210	33~330	90~900
flow (m <sup>3</sup> /h)	DN50	2~15	3~19	3~23	6~38
	DN65				
	DN80				
	DN100	2~52	3~66	3~84	6~130
	DN125	2~78	3~99	3~126	6~195
	DN150	2~104	3~132	3~168	6~260
	DN200	2~182	3~231	3~294	6~455
	DN250	2~286	3~363	3~462	6~715
	DN300	2~390	3~495	3~630	6~975
	DN350	2~520	3~660	3~840	6~1300
	DN400	2~650	3~825	3~1050	6~1625
	DN450	2~806	3~1023	3~1302	6~2015
DN500	2~962	3~1221	3~1554	6~2405	

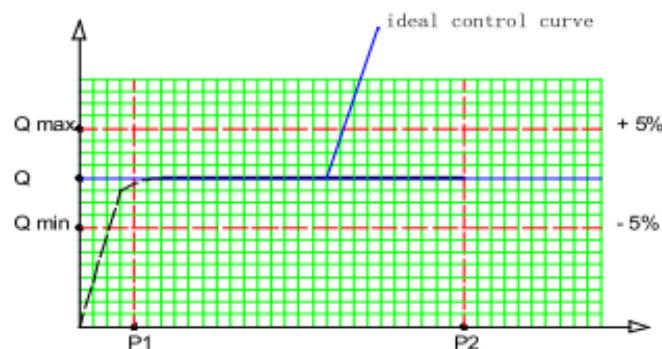

- P1 - Balancing function starting pressure
- P2 - Balancing function shut-off pressure
- Q - Nominal flow
- Q max - Maximum allowable flow deviation
- Q min - Minimum allowable flow deviation

Flange-- PN25 pressure,meet up with DIN EN1092-2/GB/T 9113.1-2000.

Installation instruction

Installation way is as following,preset room for installation and stretch(preset flexible connection room to avoid rigid traction force to valve body)

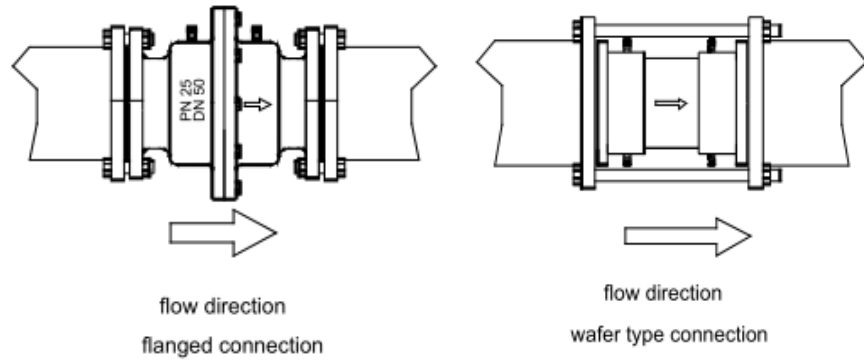

Cautions

1. Use the valve body correctly according to selection sheet, avoid wrong flow and differential pressure.
2. Pay attention to exhaust and gas keeping in system, it may cause medium blocking invalidation of regulating function or noise.
3. Pay attention to direction of flow, opposite direction may lose function.
4. Recommend to add strainer or wash line to inlet of valve, which avoids impurity blocking elements.
5. Protect inspection hole from broken or deformation to cause leakage.

Dimensions

DN15~40

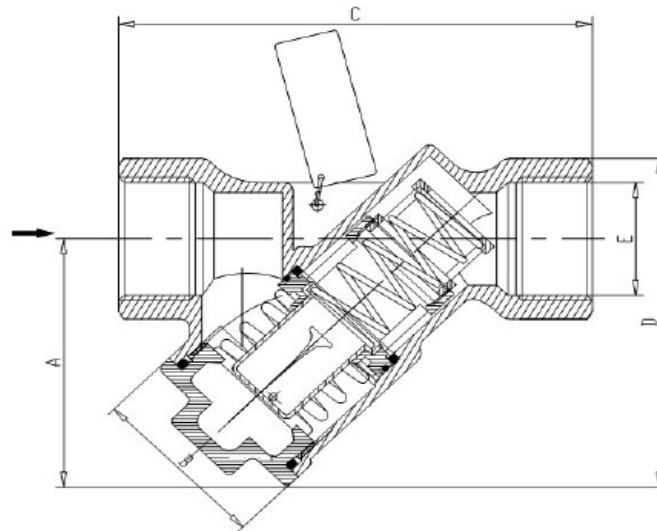

DN	A	B	C	D	E
15	67	45	105	86.5	Rp 1/2
20	67	45	105	86.5	Rp 3/4
25	67	45	117	88.5	Rp 1
32	86	55	150	113	Rp 1 1/4
40	106.5	55	171	137	Rp 1 1/2

DN50~500

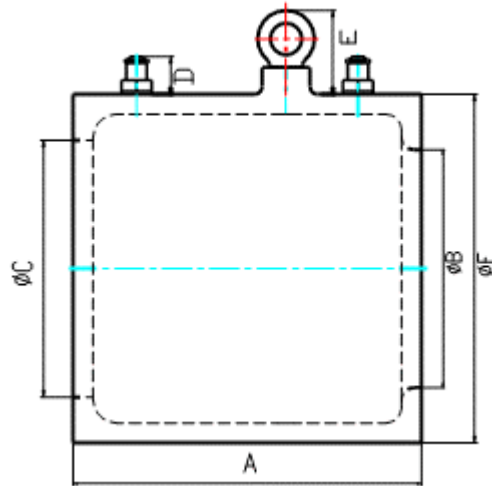

DN	A	F	B	C	D	E
50	180	106	50	83	24	-
65	180	120	65	83	24	-
80	180	132	80	83	24	-
100	220	177	100	133	24	-
125	220	193	125	140	24	-
150	220	220	150	162	24	53
200	220	280	200	214	24	53
250	220	341	250	280	24	53
300	223	400	300	328	24	69
350	223	448	350	382	24	69
400	242	510	400	440	24	69
450	242	560	450	487	24	69
500	242	618	500	545	24	69